

8- Disposición eje. Estándar
Shaft arrangement. Standard

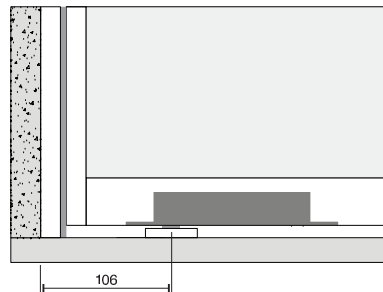
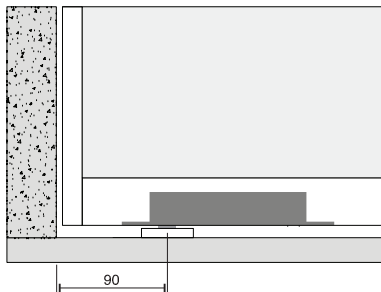
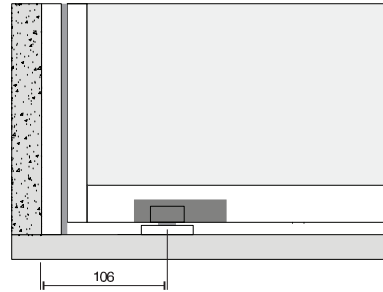
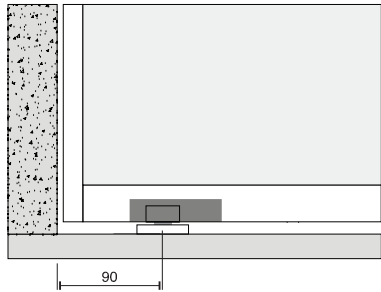

Anotaciones o especificaciones relevantes
Anotaciones o especificaciones relevantes

| | | |
|---------------------------------------------------|------------------------------------|------------------------------------------------|
| Nombre cliente Customer name | Proyecto Project | Referencia OGC OGC project reference |
| Responsable de proyecto Project manager | Correo electrónico Email | Fecha Date |

1- Acabados / Color
Finishes / Color

| | | | |
|----------------------|---------------------|----------------------|--------------------|
| 30 Pecan Brown Tex | 31 Mocha Brown Tex | 21 Negro Mate Tex | 22 Blanco Mate Tex |
| 34 Gunmetal Grey/Tex | 35 Oxide Cooper Tex | 32 Hichory Brown/Tex | 33 Anchor Grey Tex |
| | | 51 Anodic Gold | 60 Natural Oak |

21

22

30

31

32

33

34

35

51

60

| | |
|--------------------|--|
| COLOR PANEL | |
|--------------------|--|

2- Altura marco fijo SIN COMPENSADOR
Pivot door height with or without jamb WITHOUT COMPENSATOR

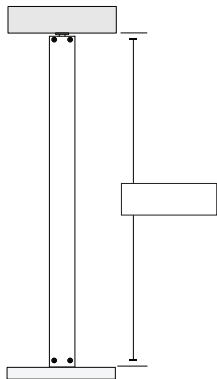

3- Grueso de vidrio (VIDRIO DEL CLIENTE)
Glass thickness (CUSTOMER GLASS)

| | |
|--------------------------|--------------------------|
| 6mm | 8mm |
| <input type="checkbox"/> | <input type="checkbox"/> |

Incluye kit de sujeción
Including fixing kit



3.A- Tipo de vidrio
Glass thickness

| | |
|-----------------|-----------------|
| VIDRIO A | VIDRIO B |
| | |

| | | | | |
|-------------------------------------------|-----------------------------|--------------------------|------------------------|----------------------|
| | 01 Extra Clear | 02 Bronze | 03 Grey | |
| | 40 Extra Clear Matte | 41 Bronze Matte | 42 Grey Matte | |
| | 60 Narrow Ribbed extra size | 61 STRECH Incoloro Matte | 62 STRECH Bronze Matte | 63 STRECH Grey Matte |
| | 70 Reflective Transparent | 71 Reflective Bronze | 72 Reflective Grey | |
| | 00 Dark Grey | | | |
| | 100 Dark Grey Matte | | | |
| Acabado Vidrio 6 mm Glass Finishes 6mm | A1 | | | |
| | A2 | | | |
| | A3 | | | |
| | A4 | | | |
| | A5 | | | |
| | A6 | | | |
| Acabado Vidrio 8 mm Glass Finishes 8mm | B1 | | | |
| | B2 | | | |
| | B3 | | | |
| | B5 | | | |
| | B5 | | | |

6- Anchura puerta pivotante sin jamba
Pivot door width without jamb

PV-F / PV-FC

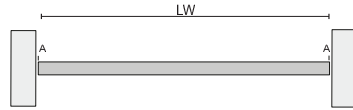

LW =

LEYENDA DE VARIABLES / VARIABLE LEGEND

| | | |
|----|-----------------------------------------------------------|------|
| LW | ANCHURA DEL HUECO DE LUZ / WIDTH OF THE LIGHT OPENING | - |
| A | FRANQUICIA DEL MARCO PIVOTANTE / PIVOTING FRAME FRANCHISE | 1 MM |